

4

3

2

1

DO NOT SCALE DRAWING

THE INFORMATION CONTAINED HEREIN IS THE EXCLUSIVE PROPERTY OF VIRGINIA PANEL CORPORATION AND IS SUBMITTED FOR USE BY THE CUSTOMER ONLY. THE DATA SHALL NOT BE DUPLICATED, USED, OR DISCLOSED IN WHOLE OR IN PART FOR ANY PURPOSE OTHER THAN TO MAINTAIN THE EQUIPMENT PROVIDED. CONSULT WITH VIRGINIA PANEL CORPORATION ENGINEERING IF MORE DETAIL IS REQUIRED.

REVISIONS			
REV	DESCRIPTION	DATE	ENGR
A	DRAWING ORIGINATION; ECN #6183	8/7/15	R GARMAN

D

C

B

A

ITA PROTECTIVE COVER

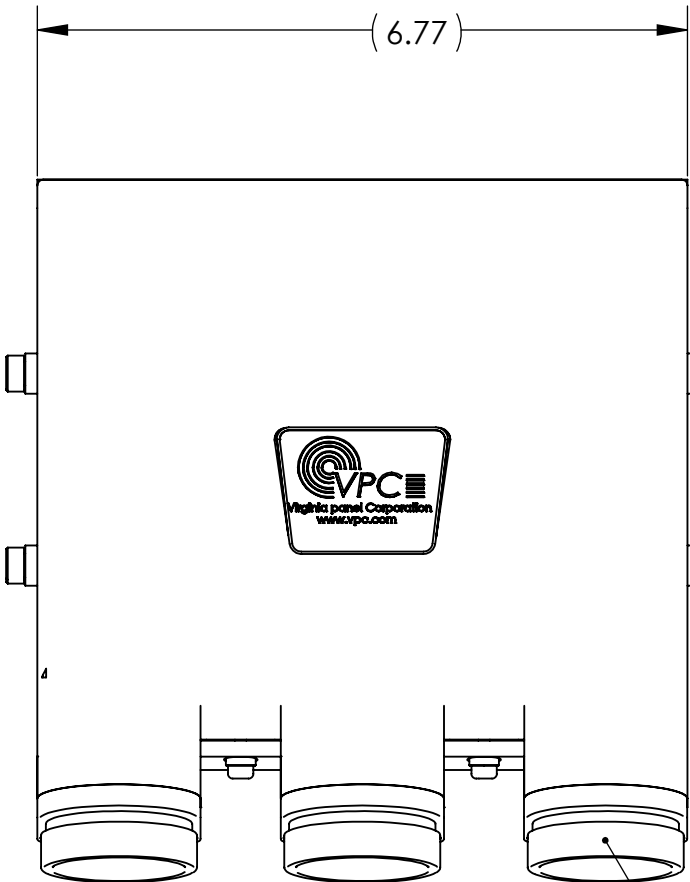
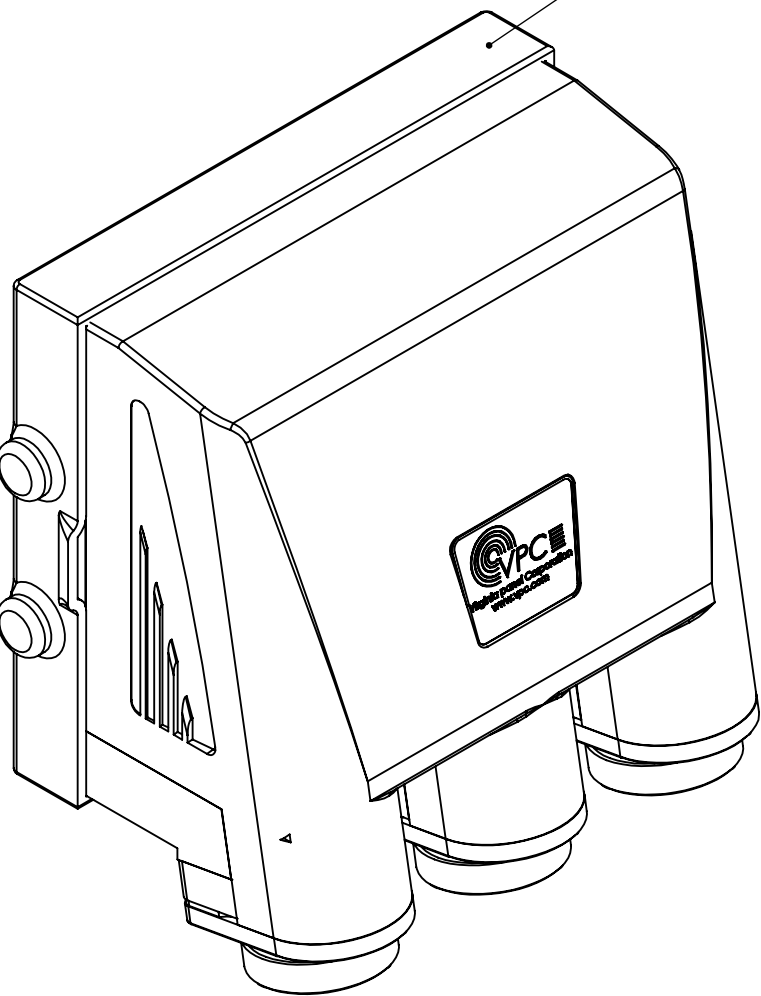

1.625-18UNEF
TYP. 3 PLCS.

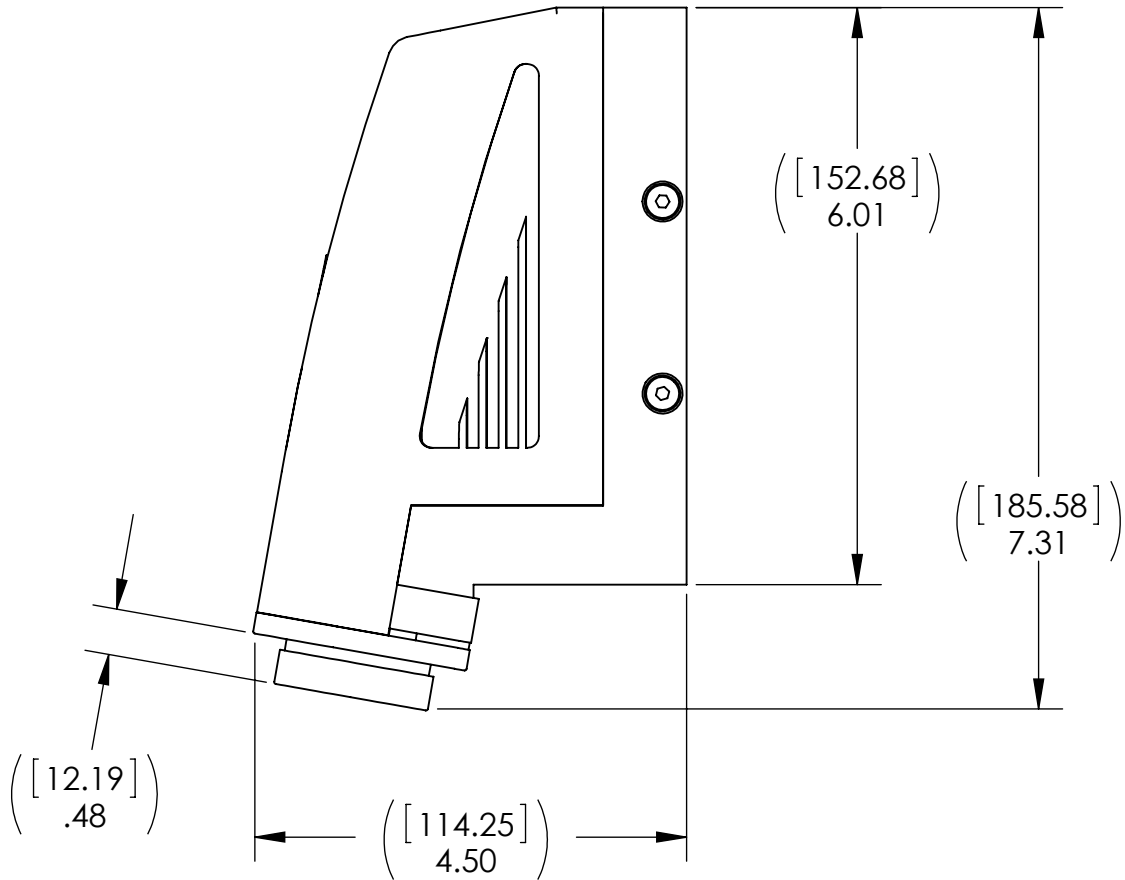
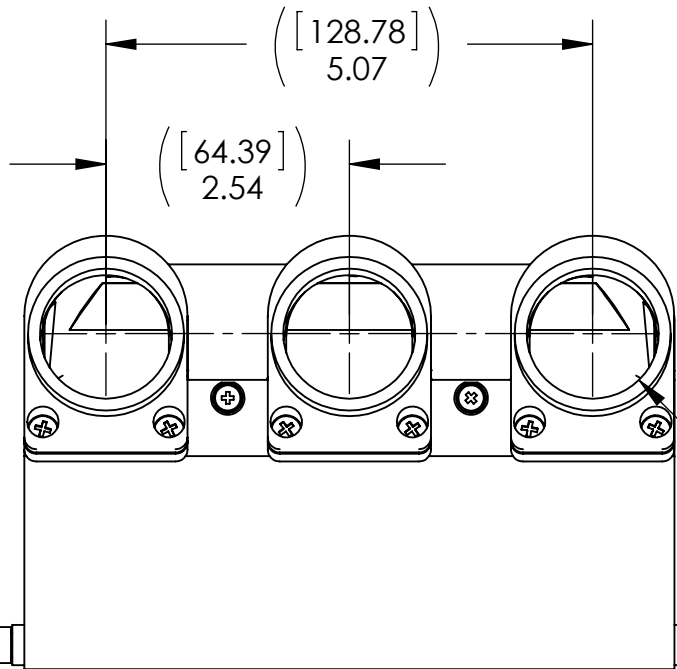

D

C

B

A

1. FOR APPLICATION USE & CARE INFORMATION CONSULT VPC USERS GUIDE @WWW.VPC.COM
NOTES:

4

3

2

1

RELATIVE CONNECTOR POSITIONS
AND WIRE ROUTING ARE GENERIC
AND MAY VARY WITH PINOUT
DIMENSIONS ARE SHOWN AS:
[MILLIMETERS]
INCHES

CUSTOMER DRAWING				
VIRGINIA PANEL CORPORATION				
WWW.VPC.COM				
ITA/ENCL 10 POS EMI				
SIZE C	CAGE CODE 18117	DWG.NO. 410104579	REV A	
SCALE: 1:2	410104579	1/15/13	SHEET	1 OF 1